



Welcome to "Artistry in Motion"

Welcome and thank you for choosing to participate in Marcus Whitman's Winterguard Home Show, "Artistry in Motion," being held on **Saturday, January 21, 2023 at 5:00 pm!** We are excited to have the opportunity once again to be able to host this event and are looking forward to our time together. Our newly renovated gym is a beautiful space to host our 11 competing guards. Here is some important information we would like to share with you:

Our main doors will open for guards and spectators at 2:30 pm. The gym doors will open at 4:00 pm, our National Anthem will be played at 4:55 pm, and the show will be at 5:00 pm. Again, thank you for your participation!

Tickets: Tickets will be available at the door for \$6.00 for students/55+ seniors and \$8.00 for adults. Credit cards will be accepted.

Guard Check-In: Each participating guard will be assigned a homeroom. Because of the computers in the school, an adult guard representative must sign a form as the guard arrives stating the room will be returned to the condition in which it was found and pay for repair or replacement for broken or missing items. A GUARD REPRESENTATIVE MUST ARRIVE WITH THE MEMBERS AND SIGN THE FORM. ROOMS WILL NOT BE ASSIGNED UNTIL THIS HAS BEEN DONE.

Guards should be dropped off at the Wayne-Finger Lakes Secondary School (BOCES at Marcus Whitman) parking lot entrance located at the rear of the building. Your guard members will be stamped upon entering the building and directed to your room. Props and equipment should enter at the same entrance. The circuit is using Competition Suite and scores and comments will be sent to you through your phone, computer, or other digital devices.

Please note only instructors and chaperones will be allowed in the guard areas. If you have guard members going home with their parents, please make arrangements in advance for the parents to meet them in the cafeteria.

Updated 12/27/22

Pre-Performance Announcements: All announcements should be typed and clearly labeled with your guard name and the time of your performance. Announcements should be turned in immediately upon check-in. Please clarify the wording with the announcer when you do a sound check. You may also email announcements to heatherkayclark20@gmail.com.

Sound Checks: Sound checks will be allowed from 3:30 pm until 4:30 pm and again during intermission (around 5:47 pm - 6:30 pm) only.

Bus Parking: Once your guard has been dropped off at the guard check-in area, your buses can unload props and park in the same parking lot. We are asking all buses and equipment vehicles to park in the BOCES parking lot located at the rear of the building.

Equipment: All equipment **MUST** be carefully padded with special attention to all sabers. All equipment will be inspected before entering the gym.

No props will be checked in before 2:00 pm.

Floors: The guards will be entering the gym from the left side of the judges and they will exit the gym using the doors on the right. Both of these doors are located near the back of the performance floor. When you are folding your floor mat, you will drop it along the left side and pull across to the right.

Cafeteria: The cafeteria will be open as of 2:00 pm with a variety of choices available. Credit cards will be accepted. **Please support our Booster Program by purchasing food as they sponsoring our home show to make this opportunity possible for our children!**

Seating: Guard members, chaperones, and your floor crew will be stamped upon arrival. The North East Color Guard Circuit allows a total of 7 staff, chaperones, and floor crew combined per unit. The floor crew will be stamped at the prop entrance. These members will be allowed to view the show from **the back side of the gym** only. Since there will be limited seating for the paying public, please remind your members to sit on the back side of the gym. They will be asked to move if they are sitting on the front side.

Guides: Your group will be escorted as it makes its way from your classroom to the body warm-up/equipment warm-up area. It's the director's responsibility to follow the time schedule.

Warm-Ups: There will be a body and equipment warm-up period prior to your performance time. While we will provide guides, it is the responsibility of the director to make sure their guard arrives for warm-ups on time. ***Warm-Up Location - Middle School Gym***

Retreat: Captains only, please. The retreat will be held immediately after the final exhibition and guard recognition. Please have your team's captains report to the hallway where the guards entered for the competition at 7:10 pm.

Comments & sheets: Please remember to pick up your music CD from the announcer's table in the gym. Remember, comments are digital and will be received through Competition Suite along with the scores. Recaps will be available at the Post Contest meeting.

Awards: All groups from each division will be receiving an award.

Post Contest Meetings: Will be held in the High School Library and will begin immediately following the show.

Smoking: There is **NO Smoking Permitted** on school grounds. Please remind your parents chaperones and floor crew of this important rule.

Directions:

From Canandaigua, NY-Take 5 & 20 East, Turn right onto NY-364 S, Turn left onto Co Rd 1, and Turn left onto Baldwin Road, Destination will be on the left (first driveway for guards and equipment / the third driveway for spectators).

From Geneva, NY-Take 5 & 20 West, Turn left onto NY-245 S, and Turn right onto Baldwin Road, Destination will be on the right (the fourth driveway for guards and equipment / the second driveway for spectators).

From Penn Yan, NY-Take Liberty Street, Turn left onto NY-364 W, Turn right onto NY-247 N, Continue straight onto Co Rd 1, and Turn right onto Baldwin Rd, Destination will be on the left (first driveway for guards and equipment / the third driveway for spectators).

From Naples, NY-Take N Main Street, Turn right onto NY-245 N, Turn left onto N Main Street, Continue straight onto Co Rd 1, and Turn right onto Baldwin Rd, Destination will be on the left (first driveway for guards and equipment / the third driveway for spectators).

FOR GUARDS & PROPS

If using GPS the address is:

Finger Lakes Secondary School
4120 Baldwin Road
Rushville, NY 14544

FOR SPECTATORS

If using GPS the address is:

Marcus Whitman High School
4100 Baldwin Road
Rushville, NY 14544

If you need to contact me the day of the show, I can be reached at the number below.

Good luck to all, enjoy the show, and thanks again for joining us!

Sincerely,

Heather Kay Clark, Director

585-943-7356

Show Schedule

Marcus Whitman Winterguard Show Schedule - January 21, 2023 @ 5:00 pm							
Guard	Room #	Pick Up Time	Practice Gym	Body & Equipment Warm Up	Arrival Time to Gym	Performance Time	Critique Order
Hinsdale Starliners Novice	311	4:38	A	4:42-4:56	5:00	5:05	1
Victor Cadet	515	4:45	B	4:49-5:03	5:07	5:12	3
Gates Chili RA	327	4:52	A	4:56-5:10	5:14	5:19	2
Naples RA	502	4:59	B	5:03-5:17	5:21	5:26	4
Corning-Painted Post RA	514	5:06	A	5:10-5:24	5:28	5:33	2
Marcus Whitman RA	312	5:13	B	5:17-5:31	5:35	5:40	4
Intermission 5:47 pm - 6:30 pm							
Hinsdale Headliners A1	308	6:01	A	6:05-6:21	6:25	6:30	1
Gates Chili A1	334	6:09	B	6:13-6:29	6:33	6:38	2
Victor SA	516	6:17	A	6:21-6:37	6:41	6:46	3
Gates Chili IA	337	6:25	B	6:29-6:45	6:49	6:54	3
Luminosa Senior	306	6:33	A	6:37-6:53	6:57	7:02	1
Retreat & Critique 7:15 pm							

Map of School

Marcus Whitman High School

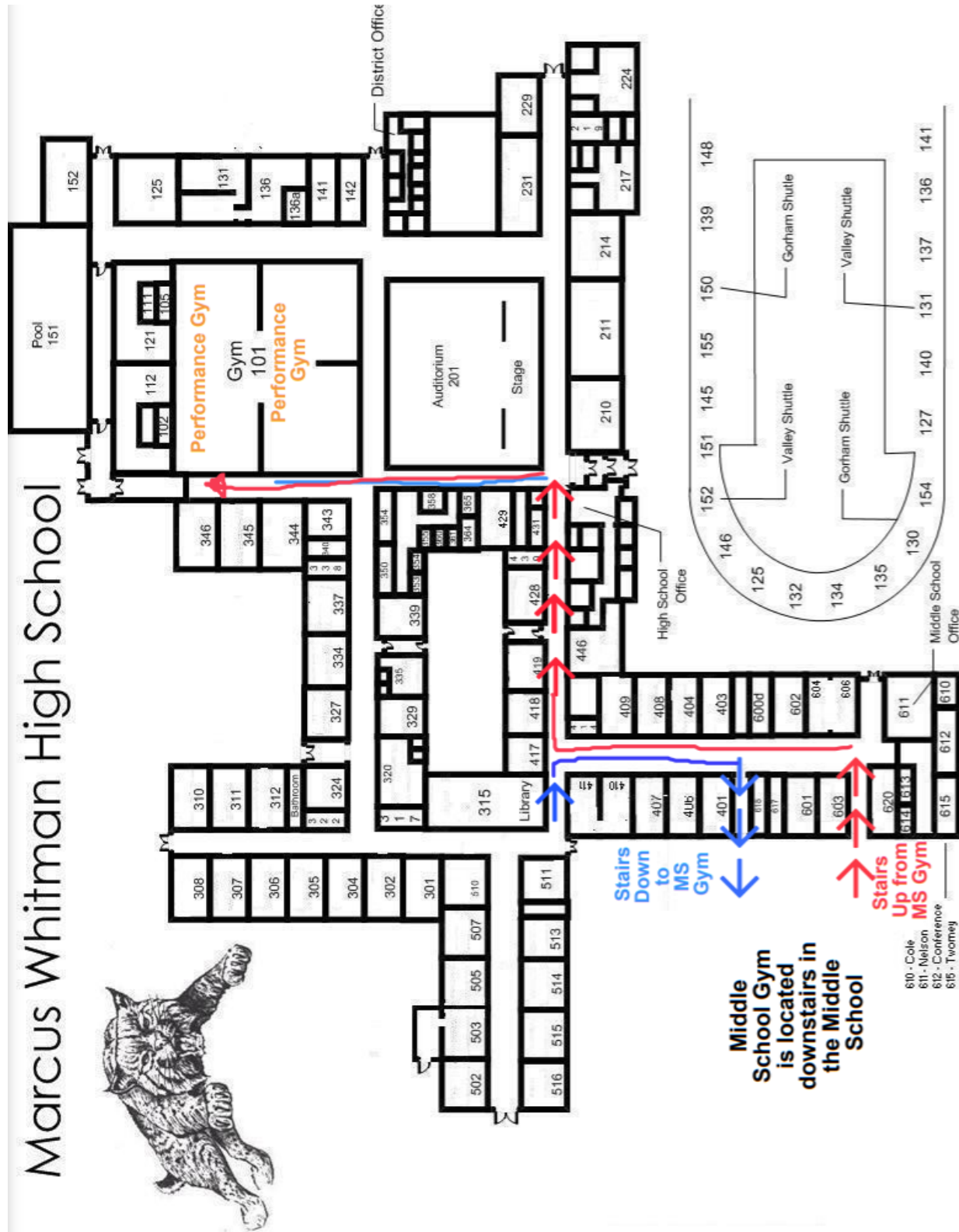

Middle School Gym is located in downstairs in the Middle School

- 610 - Cole
- 611 - Nelson
- 612 - Conference
- 615 - Twomey

CONCESSIONS



Please enjoy our Whitman Cafe!

Pizza - \$2 a slice

Walking Taco - \$3

Macaroni & Cheese - \$3

Chili - \$3

Cowboy Chili - \$4.50

Hot Dogs - \$2

Chili Dog - \$3

Candy - \$2

Soda/Water - \$1

20oz Gatorade - \$2

Popcorn - \$2

Chips - \$1

******credit cards accepted******

The Marcus Whitman Winterguard Artistry in Motion Winterguard Show

Homeroom Agreement

Date: _____

Guard Name: _____

Name: _____
(please print)

As the representative for the above-named unit, I agree to return the homeroom to which we have been assigned to the condition in which it was found. Further, I understand that any electronic devices that may be in the room (i.e. computer, TV) are not to be used.

I also understand that the unit's Director and/or the Director's organization will be held responsible for any damages or missing items.

Do not open or go through the teacher's desk or any closed files.

Homeroom Assigned: _____

Signature: _____

Title: _____

**The Marcus Whitman Winterguard
Artistry in Motion Winterguard Show**

Floor Crew/Staff/Chaperone
Sign-In Sheet

GUARD: _____ CLASS: _____

1. _____

2. _____

3. _____

4. _____

5. _____

6. _____

7. _____

DIRECTOR: _____