

Presented by the Marcus Whitman Band & Guard Boosters

# "ARTISTRY IN MOTION"

Marcus Whitman  
Winterguard Home Show



January 27th, 2024 @ 6:00pm

Thank you for choosing to participate in Marcus Whitman's Winterguard Home Show, "*Artistry in Motion*," being held on **Saturday, January 27, 2023 at 6:00 pm!** We are so excited to once again host this event and celebrate over 45 years of Winterguard at Marcus Whitman! Our newly renovated gym is a beautiful space to host our 11 competing guards. Here is some important information we would like to share with you:

**Order of Events:** Our main doors will open for guards and spectators at 3:30 pm. The gym doors will open at 5:00 pm, with National Anthems being played at 5:55 pm and the show kicking off at 6:00pm. Again, thank you for your participation!

**Tickets:** Tickets will be available at the door for \$7.00 for students/55+ seniors and \$9.00 for adults. Children ages 2 and under are free. Credit cards will be accepted.

**Guard Check-In:** Guards should be dropped off at the Wayne-Finger Lakes Secondary School (BOCES at Marcus Whitman) parking lot entrance located at the rear of the building. Each participating guard will be assigned a homeroom upon arrival. Due to the technology equipment present in each homeroom, each unit is required to complete a form (included in this packet) assuming responsibility for any damaged or broken materials if they are broken while occupying the room. **Please advise that a member of staff must arrive with the guard with this signed form, or else we will be unable to assign a room until a staff member arrives and signs the form.**

Please note that only instructors and chaperones will be allowed in the guard areas. If you have guard members going home with their parents, please make arrangements in advance for the parents to meet them in the cafeteria, outside the spectator entrance, etc.

**Prop Check-in:** Props should be dropped off at the same location as guard members. Upon approaching the entrance, there are two doors: one to the left and the other to the right. Please ensure that guard members and staff use the right-hand entrance while props and parent volunteers use the left-hand entrance. Doorways in the school have **80 inches** of clearance; please ensure before arriving at the school that all props are folded/packed in such a way that they can make it through these doorways.

**Prop/Bus Parking:** Once props are unloaded, equipment vehicles will be directed to park in the main lot in front of the Aquatics Center. This is where props will be directed and re-loaded following your performance. After dropping off students, buses will be directed to park in the BOCES parking lot. If you are also using bus(es) to transport props, they will be directed to park in the Aquatics Center lot with other equipment vehicles and are encouraged to return to the BOCES lot for pickup following being re-loaded with equipment/props.

**Pre-Performance Announcements:** All announcements should be typed and clearly labeled with your guard name and the time of your performance. Preferably, please email your announcements to [austin.j.kephart@icloud.com](mailto:austin.j.kephart@icloud.com) in the week before the show. If absolutely necessary, announcements can be turned in immediately upon check-in. Please clarify wording, pronunciations, etc. with the announcer when you do a sound check. If you do not submit an announcement, the description provided for the program will be read instead.

**Audio/Sound Checks:** Sound checks will be allowed from 4:30 pm until 5:30 pm and again during intermission (around 6:47 pm - 7:20 pm) only. It is recommended to both submit your audio track via mp3 file to [austin.j.kephart@icloud.com](mailto:austin.j.kephart@icloud.com) and **also** arrive with a physical, CD copy. The sooner this, along with any announcements, can be submitted: the better.

**Equipment:** All equipment **must** be carefully padded with special attention to all sabers. All equipment will be inspected before entering the gym. Please note that no props will be checked in before 3:00 pm.

**Floors:** The guards will be entering the gym from the left side of the judges and they will exit the gym using the doors on the right. Both of these doors are located near the back of the performance floor. The timeline will be vertical; you will drop your mat along the audience's left side and pull across to the right.

**Cafeteria:** The cafeteria will be open as of 3:00 pm with a variety of choices available. Credit cards will be accepted. Please advise the form at the end of this packet which will allow students and their families to pre-purchase meal vouchers that can be used at concessions.

**The Marcus Whitman Band & Guard Boosters would greatly appreciate your support via concessions.**

**Seating:** Guard members, chaperones, and your floor crew will be stamped upon arrival. The North East Color Guard Circuit allows a total of 7 staff, chaperones, and floor crew combined per unit. The floor crew will be stamped at the prop entrance. These members will be allowed to view the show from **the back side of the gym** only. Since there will be limited seating for the paying public, please remind your members to sit on the back side of the gym. They will be asked to move if they are sitting on the front side.

**Guides:** Please advise that, to keep our show running as smoothly as possible, units are not permitted to travel to their warm-up area without their student guide(s). Guides will respectfully provide time warnings to staff but, as per NECGC guidance, it is the responsibility of staff to ensure units are prepared to move at required times. Please also note that we will be utilizing "iPhone time" to ensure everyone is on the same page, as occasionally the school's clocks run either a few minutes behind or ahead.

**Between Performances & Retreat:** As noted in the included schedule, retreat will be held following the Marcus Whitman Indoor Percussion Ensemble's exhibition performance at 8:00 pm and the inaugural presentation of the Marcus Whitman Band & Guard Boosters' **Brady L. Rouse, Jr. Memorial Award** at approx. 8:15 pm. We are politely asking as many unit members, chaperones, staff (with the exception of those attending critique), etc. as possible to stay for this presentation to honor Brady's legacy, one which is near and dear to many of our alumni, staff, and members.

**Retreat:** We kindly request that only captains participate in retreat. Please have your team's captains report to the hallway where the guards entered for the competition at 8:10 pm. This will also be announced at the appropriate time.

**Comments & Recaps:** Please remember to pick up your music CD from the announcer's table in the gym. Comments will be received through Competition Suite along with scores. Recaps will be available at the Post Contest meeting.

**Awards:** All groups from each division will receive an award.

**Post Contest Meeting:** Critique will be held in the High School Library (see enclosed map) and will begin immediately following the show.

**Smoking:** Per New York State Law, any use of cigarettes, e-cigarettes, tobacco, or THC/CBD products is **not allowed** on campus. Anyone seen using any product of this variety will be escorted off campus and not be allowed to return.

#### **FOR GUARDS & PROPS**

If using GPS the address is:

Finger Lakes Secondary School  
4120 Baldwin Road  
Rushville, NY 14544

#### **FOR SPECTATORS**

If using GPS the address is:

Marcus Whitman High School  
4100 Baldwin Road  
Rushville, NY 14544

Good luck to all, enjoy the show, and thanks again for joining us! If you have any questions on the day of the show, please feel free to reach me at the number below!

Sincerely,

**Austin Kephart**

Home Show Coordinator

Marcus Whitman Band & Guard Boosters

(585) 430-0057 | [austin.j.kephart@icloud.com](mailto:austin.j.kephart@icloud.com)

## Show Schedule

<b>Artistry in Motion' Winterguard Show'</b> <b>Show Schedule - January 27, 2023 @ 6:00PM</b>							
<b>Guard</b>	<b>Room #</b>	<b>Pick Up Time</b>	<b>Practice Gym</b>	<b>Body &amp; Equipment Warm Up</b>	<b>Arrival Time to Gym</b>	<b>Performance Time</b>	<b>Critique Order</b>
Hinsdale Starliners Novice	334	5:38	A	5:42-5:56	6:00	6:05	1
Victor Cadet	305	5:45	B	5:49-6:03	6:07	6:12	3
Corning-Painted Post RA	302	5:52	A	5:56-6:10	6:14	6:19	2
Naples RA	311	5:59	B	6:03-6:17	6:21	6:26	4
Gates Chili RA	308	6:06	A	6:10-6:24	6:28	6:33	2
Marcus Whitman RA	312	6:13	B	6:17-6:31	6:35	6:40	4
<b>Intermission 6:47 - 7:20</b>							
Hinsdale Headliners A1	337	6:51	A	6:55-7:11	7:15	7:20	1
Gates Chili A1	307	6:59	B	7:03-7:19	7:23	7:28	1
Greece A1	327	7:07	A	7:11-7:27	7:31	7:36	2
Victor SA	304	7:15	B	7:19-7:35	7:39	7:44	3
Gates Chili IA	306	7:23	A	7:27-7:43	7:47	7:52	3
<b>Marcus Whitman Indoor Percussion Ensemble (EXHIBITION) - 8:00PM</b> <b>Retreat &amp; Critique 8:15pm</b>							

# MWCS CAMPUS MAP

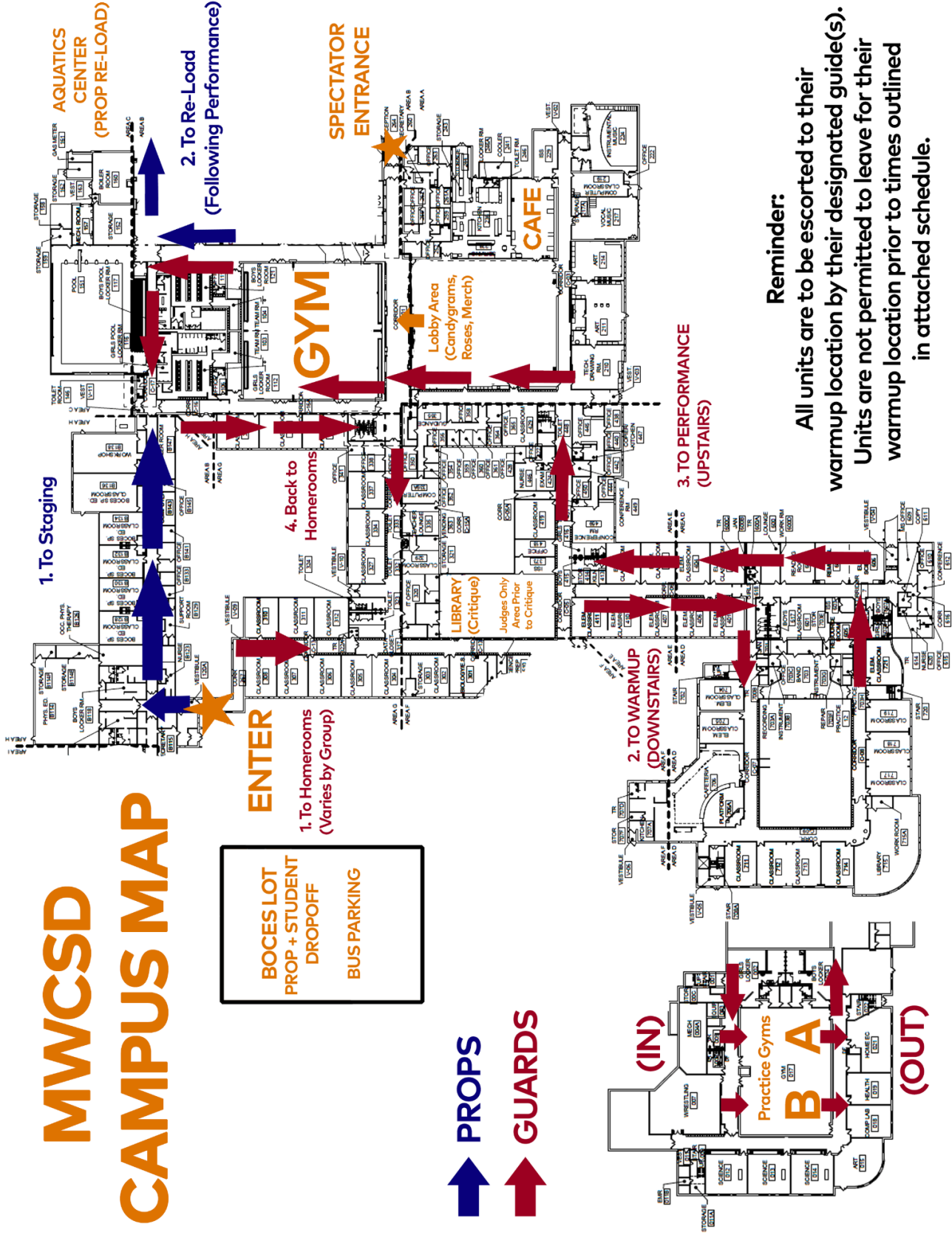

## Reminder:

All units are to be escorted to their warmup location by their designated guide(s). Units are not permitted to leave for their warmup location prior to times outlined in attached schedule.

**Marcus Whitman Winterguard  
Artistry in Motion Winterguard Show**

Homeroom Agreement

Date: \_\_\_\_\_

Guard Name: \_\_\_\_\_

Name: \_\_\_\_\_

(please print)

As the representative for the above-named unit, I agree to return the homeroom to which we have been assigned to the condition in which it was found. Further, I understand that any electronic devices that may be in the room (i.e. computer, TV) are not to be used.

I also understand that the unit's Director and/or the Director's organization will be held responsible for any damages or missing items.

Do not open or go through the teacher's desk or any closed files.

Homeroom Assigned: \_\_\_\_\_

Signature: \_\_\_\_\_

Title: \_\_\_\_\_

**Marcus Whitman Winterguard**  
**Artistry in Motion Winterguard Show**

Floor Crew/Staff/Chaperone  
Sign-In Sheet

GUARD: \_\_\_\_\_ CLASS: \_\_\_\_\_

1. \_\_\_\_\_

2. \_\_\_\_\_

3. \_\_\_\_\_

4. \_\_\_\_\_

5. \_\_\_\_\_

6. \_\_\_\_\_

7. \_\_\_\_\_

DIRECTOR: \_\_\_\_\_



# CONCESSION VOUCHER ORDER FORM

The Marcus Whitman Band & Guard Boosters are excited to offer pre-paid concessions vouchers to students that parents can purchase ahead of time. This program is designed especially for younger guard members whose parents may prefer not to carry cash and/or cards or want to guarantee their child has something to eat at the show. \$10 vouchers are available that can be used exclusively at our show's concession stand. Please note, participation is completely optional and concessions will be accepting cash or card as payment.

**Directors:** If you and/or your guard's parents choose to participate in this program, we respectfully request that the bottom portion of this sheet be returned via USPS by January 19th along with payment. Any checks should be made payable to 'Marcus Whitman Band & Guard Boosters' and sent to PO Box 7, Canandaigua, NY 14424.

Any ordered vouchers will be given to directors when their unit arrives at the show. It is the responsibility of directors to keep track of who has ordered vouchers and distribute them accordingly.

Please observe our concessions offerings and pricing below for your convenience:

Pizza - \$3 a slice | Walking Taco - \$4 | Macaroni & Cheese - \$3  
Hot Dogs - \$3 | Candy - \$2 | Water - \$1 | Soda - \$2 | 20oz Gatorade - \$3  
Popcorn - \$2 | Chips - \$1 | Hostess Snacks - \$1

---

## CONCESSION VOUCHER ORDER FORM

\_\_\_\_ Yes, payment is enclosed for \_\_\_\_ concession vouchers (\$10 each).

Unit: \_\_\_\_\_